

NOTICE OF MEETING

HERITAGE ADVISORY COMMISSION

Date: Wednesday: December 10th 2014
Location: Seniors Village (Paul Anderson Room)
Entry Code: 1976
Time : 7 pm

AGENDA

1. CALL TO ORDER: 7PM
2. ADOPTION OF MINUTES: February 13th 2014
3. ADOPTION OF AGENDA
4. BUSINESS ARISING
 - a. Letter to Council: little response from Council on roundabouts and no information on a plan for the West Summerland Train Station
 - b. Sam McGee sign completed, installed, thank you to Dave Hill and Public Works for their assistance
 - c. Heritage Home Tour: this was discussed and Gregory and Walker were supposed to talk to potential heritage home owners: didn't do it
5. NEW BUSINESS
 - a. Heritage Lost: Gartrell barn and Featherstonhaugh home
 - b. BC Heritage Week February 16-22. Theme: "Main Street: At the Heart of the Community. Ideas, perhaps an article, tour in the Spring ?
 - c. Selection of Heritage Home, site and tree for 2015
 - d. Proposed Skateboard park on school property
 - e. Ornamental Garden 100th anniversary 2016, request funds for signage. This Society get a substantial larger municipal grant than us and technically PARC is not in Summerland
 - f. Renewal of Lease for Fur Brigade Trail Linear Park
 - g. Okanagan Historical Society article about our heritage buildings, sites and trees.
6. ADJOURNMENT

****INCLUDED IN THIS EMAIL****

1. NOTICE OF MEETING
2. MINUTES OF FEBRUARY 13TH 2014 MEETING
3. COPY OF LETTER TO COUNCIL
4. ADDENDUM TO AGENDA

HERITAGE ADVISORY COMMISSION

MINUTES

February 13 2014

Members: S. Johnson, M. Walker, M. Trainer, D. Gregory
Regrets: B. Raymond, Lori Ducharme, Councillor Waterman
Public: K. Selinger, S. Selinger, D. Hildebrand

1. CALL TO ORDER: 7:03 pm
2. ADOPTION OF MINUTES: November 20 2013 as amended
Trainer/Walker CARRIED
3. ADOPTION OF AGENDA: addition of Heritage sites and tree lists
Trainer/Johnson CARRIED
4. BUSINESS ARISING
 - a. Status of wraparound of electrical box at former Darke House site:
Public Works explained that the electrical box at the Darke House site is a high voltage box and a wraparound should not be done.
 - b. Status of naming roundabouts: The Commission has still not heard from Municipal staff or Council regarding this matter

MOTION: THE COMMISSION DIRECTS THE CHAIR TO WRITE TO MAYOR AND COUNCIL REGARDING THIS ON-GOING MATTER

Trainer/Walker CARRIED

- c. Status of plans for West Summerland Train Station: The Commission has not heard for Municipal staff or Council regarding this matter

MOTION: THE COMMISSION DIRECTS THE CHAIR TO WRITE TO MAYOR AND COUNCIL REGARDING THIS ON-GOING MATTER

Walker/Johnson CARRIED

At two previous meetings the Commission agreed to select the West Summerland Train Station site as the heritage site for 2014, provided there exists a municipal plan for the site. There is apparently no plan for this site, so the Commission should select another heritage site.

MOTION: BECAUSE THERE IS NO APPARENT MUNICIPAL PLAN FOR THE WEST SUMMERLAND TRAIN STATION, THE COMMISSION NOW SELECTS THE SAM MCGEE SITE AS THE HERITAGE SITE FOR 2014

Johnson/Trainer CARRIED

- d. Select Heritage tree for 2014 There was no recommendation from the Commission members. Ken and Sammy Selinger mentioned that the that twin 'stewartii cypress' trees at 6310 Peach Orchard Road would be a good choice. They offered to examine the trees and report back to the Commission and consider those trees for this year's selection.

- e. Statement of Significance for Clouston house. Since the last meeting the owner of the Clouston home does not want to pursue heritage designation.

5. NEW BUSINESS

- a. Heritage Site/ sign for 2014. If the plan is not available, the Trans Canada Trail Society wishes to partner with the Heritage Commission and fund a sign about Sam McGee
The Heritage home for 2014 is the Ted Atkinson home (Summerland Sweets)
- b. Heritage Week: newspaper article, Cherry Lane Mall. Brian Wilson from OATS does not wish to host a heritage event at Cherry Lane Mall this year
- c. Heritage Home Tour: This topic was thoroughly discussed. Walker and Gregory will explore possible heritage homes and report back to the Commission. Homes being considered included, Harrison, Cartwright, Bredon Hill, Faircrest, Superintendent's residence at PARC, Bowering, Sutherland and Shady Maples
- d. Gartrell barn status: This building is on the heritage inventory list but the structure is now significantly weaker and for safety concerns needs to be demolished. The Commission had explored the possibility of moving the building some years ago, but even then the logs were too weak to tolerate a move. The Commission thanks the Gartrell family for informing the Commission of its status
- e. Treasurer's report: \$688.95
- f. Heritage Tree and Site Lists. There was a desire to compile a list of selected trees and sites with the year these were selected. This would require going through the old Minutes and identifying the years. This will be presented at the next meeting.

6. ADJOURNMENT

HERITAGE ADVISORY COMMISSION

February 16, 2014

RE: TWO ON-GOING HERITAGE COMMISSION ITEMS

Dear Mayor and Council

As Chair of the Summerland Heritage Advisory Commission, I have been directed by the Commission members to write to Mayor and Council regarding two on-going heritage commission items.

The first item is the **naming of the three roundabouts** in Summerland. These recommendations were made almost two years ago and the Commission has not heard from Council on this issue. The Commission recommends that the roundabout at the corner of Jubilee and Rosedale be named the "MacDonald Roundabout" to honour the now demolished MacDonald School and S.A. MacDonald: a beloved teacher and principal. The second roundabout is located at the intersection of Prairie Valley Road and Rosedale Avenue. The Commission recommends the name "Pierre Roundabout". Antoine Pierre's home was located quite close to this site and he lived there prior to the founding of Summerland in 1902. As for the third, newest roundabout, the Commission recommends the name "Fraser Smith Roundabout". Fraser was a very well known personality in Summerland and he was tragically killed at that intersection of Victoria and Prairie Valley Roads.

The second item is equally on-going. The Commission has requested **a municipal plan for the West Summerland Train Station site**. The Commission is not asking for new funding to create some site or structure, we are only asking for a plan for this site. This has been discussed many times by the Kettle Valley Steam Railway Society and over the past two years by the Heritage Commission. Over the past two years, both the Kettle Valley Steam Railway Society and the Commission have hoped that some type of action would be approved by Council to celebrate the 100th Anniversary of the Kettle Valley Railway in 2015.

Other communities are planning events for this celebration, but with Summerland's history and the number of the Railway Directors who previously owned land in Summerland, it is especially important that we have a significant event. And of course, this would be an excellent promotion for our railway.

Your response to these two items would be appreciated

Sincerely



David Gregory
Chair

ADDENDUM

1. Proposed skateboard park:

The previous Council proposed to build a skateboard park at the north east corner of the Secondary School playing field. The Heritage Advisory Commission should remind Council that when the Middle School and the new Jubilee Road plans were presented to Council in the year 2000, Council agreed to the demolition of MacDonald School (a heritage building) on the condition that a new track and field facility would be built at the north east corner of the playing fields. The recommendations of Councillors and School Trustees were rejected by Municipal and School District staff and staff recommended the demolition of the school and the creation of a track and field.

This is the plan that Council approved

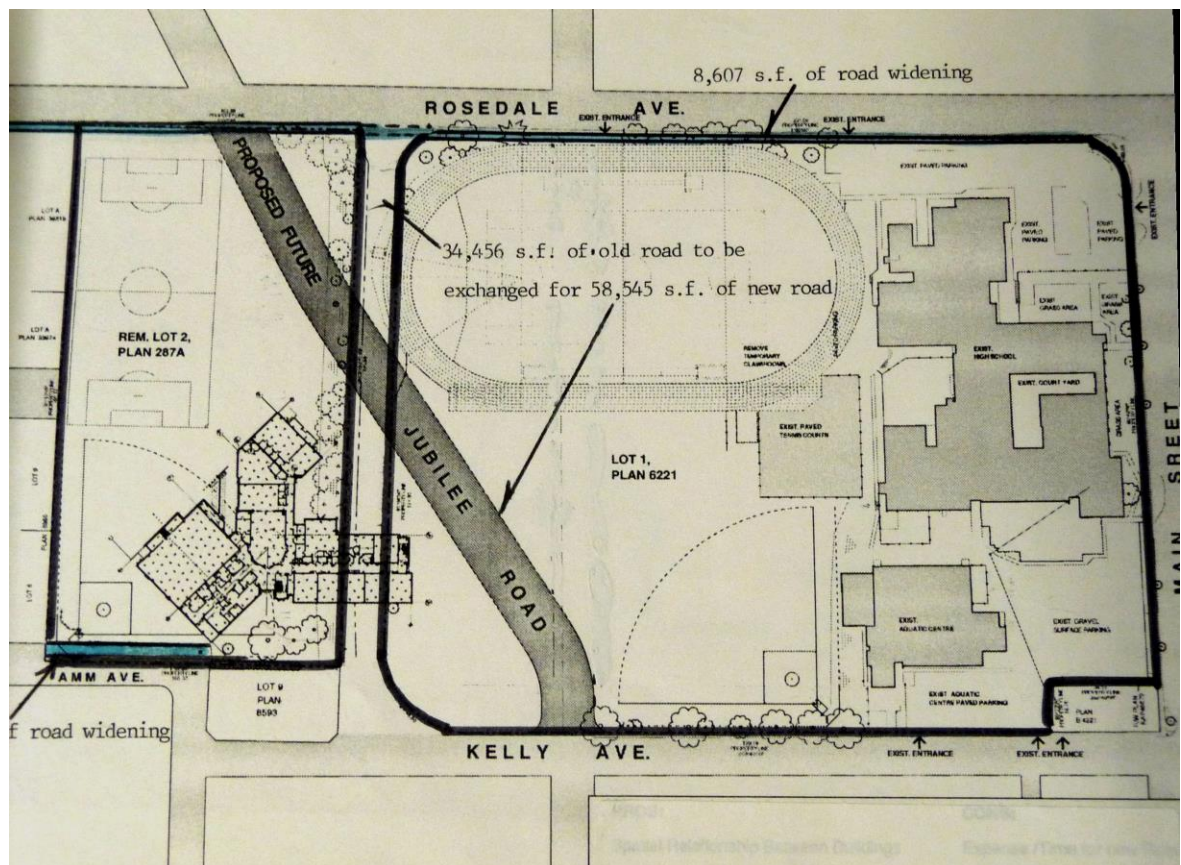

The School District owns one half of the Municipal Hall and review revenue from the tenants in that building. There is more than enough funds to pay for a track and field facility. **The Heritage Advisory Commission should remind both the Council and the School Board of this agreement.**

2. FUR BRIGADE TRAIL LINEAR PARK

This trail extends from Priest Camp to the Lookout above Okanagan Lake. It is 4.1 km long and 300 meters wide. Because the trail is older than 1846, it is protected by the Heritage Conservation Act.

One portion of this trail extends into the Central Okanagan Regional District (CORD). This portion is leased from CORD for ten years at a cost of \$500. This lease expires in 2016. **The Heritage Advisory Commission should remind the Council that this lease needs to be renewed.**

3. Heritage Building Site and Tree for 2015

HERITAGE BUILDINGS INVENTORY 2014



Samuel Maclure's Bank of Montreal



R.B. Angus's orchard home. Co-founder of the Canadian Pacific Railway, National President of Bank of Montreal

In 1983 consultant Robert Hobson conducted a survey of heritage buildings in the Okanagan and Similkameen Valleys. According to Hobson, Summerland had the highest number of "Class A" buildings in the study. Summerland came a close second in the number of "Class B" buildings and clearly had the highest number of "Class C" buildings in the study.

The Summerland Museum created an “Inventory of Heritage Buildings” in 1988. The Summerland Heritage Advisory Commission created a “Heritage Inventory in 2005 and amended in 2001 and 2007. Only one heritage building has official provincial heritage status: the George Ryga Centre. All other identified heritage buildings and sites are deemed “red flagged”. This means that when a building permit is issued for these structures (demolition, renovation) the District and the Heritage Advisory Commission can attempt to request that the owners preserve the heritage elements of the structure.

Building	Owner	Address	Year	Value
Gartrell Barn	David & Pat Gartrell	Gartrell Road	1896	First commercial fruit rancher
Gartrell Home	David & Pat Gartrell	Gartrell Road	1896	First commercial fruit rancher
Landry Sod Roof Cabin	Cathedral Ventures	Landry Crescent	1888	Tom Ellis cabin
Lakeside Presbyterian Church	Trustees of St. Andrews Presbyterian Church	5505 Butler Street	1909	Unique exterior historic organ in interior of church
Hogg Store	Sonia Schoegl	13020 Lakeside Drive	1907	Only remaining commercial building in Lowertown
Methodist Church Manse	Kathleen Moys	5711 Gowan	1907	Exterior now altered, unique basement
R.B. Angus	John and Sandy Nicholson	11777 Dodwell Avenue	1904	Knighted twice founder CPR., president BoM
St. Stephen's Anglican Church	Synod of the Diocese of Kootenay	9311 Prairie Valley Road	1909-1910	Exterior and Memorial gardens, stain glass
Bisgioni “The Stone House”	Zias Restaurant	14015 Rosedale Avenue	1916	Stone architecture, interior stone walls
Major Hutton Home “Bredon Hill	Steve Pearce	12405 Reynolds Avenue	1909	Famous Samuel Maclure design. Hutton Boer War Vet.
Col Robert Cartwright		14605 Cartwright Avenue	1907-1908	Arts and Craft design exterior, Boer War vet. Son of Sir Richard Cartwright

Barclay Ranch House	Art & Carrie Hazenboom	12409 South Victoria	1886 + 1888	Combination of W.L Jones and Alex McLennan. Origin Trout Creek Ranch House Trout Creek= Summerland
Alex Steven Home	R. Calhoun	13019 Steven Avenue	1910	Setting of home and exterior architecture
Spencer Sister's Home	Ken & Sammie Selinger	13822 Rumball Avenue	1910-1911	BC's most famous female photographer, Bill Miner
Canyon Ranch Barn	Towgood family	4100 Morgan Avenue	1889	Pioneer, historic barn
Will Ritchie Home	Robyn Doell	15005 Washington Avenue	1910	Pioneer, Queen Ann Revivial architecture
Ken Hogg Home	Eileen Cuneo	6919 Switchback Road	1904	Pioneer, setting of home, exterior architecture
Balcomo Post Office	Joe Bienz	11809 Doherty	1907	Unique exterior, historic value, Upper Trout Creek building
Balcomo Lodge, R.H. Agur home	Mrs. Walter Powell	11016 Rutherford Avenue	1906	Unique exterior, home of pioneer R.. Agur
Gutormusson home	Dirty Laundry	8206 Giants Head Road	1910	Tudor Revival design, woodwork by Neilson brothers
George Ryga home	George Ryga Society	5109 Caldwell Street	1939	Home of B.C.'s most famous playwright
Zimmerman's Gulch	District of Summerland	Between Giants Head Road and Highway 97		Original road linking Trout Creek to Giants Head Road.
Downtown Memorial Park	District of Summerland	Wharton Street	1948	1948 Memorial Parks Committee
Living Memorial Athletic Park	District of summerland	Snow Avenue	1948	1948 Memorial Parks Committee, includes hillside around park
Superintendent's house	PARC	PARC	1924-1925	Sie of Spring Fairs, Federally protected

				heritage building
Kettle Valley Railway Bridge	Province of B.C.	Trout Creek Canyon	1913	Historic, engineering feat
Irrigation Flumes	District of Summerland	Morrow and Denike Avenues	1903-1910	Latimer engineer. Summerland Development Company project
Priest Encampment/ St Joseph Station	50 acre historic Park District of Summerland and Michel Carnel	Garnett Lake	1845	Father Nobili established with Grand Chief Nicola in 1845
Bank of Montreal	Bank of Montreal	9902 Main Street	1917	Samuel Maclure design, Harvey builder
Monro home	Dingwall	5007 Monro	1910	Classic pre-fab design
Bowering home		10515 Quinpool	1910	Setting of home, postmaster
Arkell home/bakery	District of Summerland	Henry Avenue	1909	Road foreman, Clough bakery
William Harvey Home		11919 Jubilee Road	1907	Both exterior and interior of home, setting of home
Hillborn home	Sharon Hill	15403 Logie	1912	Setting of home, exterior architecture
Isaac Blair home and apple sheds		Garnett Valley Road	1909-1910	Isaac Blair Company Boston Mass. Founder, Reeve
Granite City Waggon Trail		Bentley Road to Crescent Beach	1885-1895	Supply route for Granite City near Princeton, built by Captain Thomas Shorts
Sir Edward Clouston home	Bobbi Weller	8617 South Victoria Road	1910	National general manager BoM, Bank Act, played in first official hockey game in Montreal 1875
Blewett Home	Terri Dekur & Rene Goldman	6708 Peach Orchard Road	1920	Setting of home and gardens
Ralph White		Solly Road	1915	Editor of Summerland Review, Reeve. Exterior architecture
A.J. Beer Home		Jubilee Road	1912	Unique

				architecture, Beer Store pioneer
Rev. Harrison Home		Turner Road	1910	Pioneer, home rotated on property but home still intact
Badminton Hall		12807 Rosedale Avenue	1930	Unique architecture
F.E. Atkinson home	Micheal and Janet Braid	6317 Hilborn at Canyon View Road	1930	Researcher, Summerland Experimental Far, founder Summerland Sweets, Reeve
C.J. Thompson		10002 Haddrell Avenue	1908	First Council, later Reeve, unique exterior design
Summerland Supply Company	Dan Ashton	10124 Main Street	1906	Oldest store on Maint Street
Canyon Ranch home	Jeff Bailey	4100 Morgan	1908	Site of first school in Trout Creek, Pioneer orchard
Higgin Home		Denike Avenue	1908	One of first homes in Balcomo, Prairie Valley
IOOF Hall		Main Street	1910	Moved to site from Lowertown, centre of community events
Loomer Home	Irene Harris	Kelly Avenue	1910	One of the first houses in downtown, Loomer early teacher
Tom McAlpine home	Betty and Gary Raymond	12216 Lakeshore Road	1908	Road engineer, McAlpine Bridge
Okanagan Fur Brigade Trail Linear Park	District of Summerland	Garnett Lake	First Nations trail estimated 6,000 years old	Official Centennial Project 2006, Priest Camp to leased area in Central Okanagan Regional District
"Faircrest"	Mack Hair	6114 Faircrest Avenue	1917	Samuel Maclure designed building,

Muir Steuart		11311 Quinpool	1930	Tudor Revival exterior design
William Kerr		14813 Tada Avenue	1904	Kerr and later Theed were pioneer fruit inspectors
Dr. Lipsett home		6532 Lipsett Crescent	1907	Early veterinarian, brother-in-law to J. M. Robinsons
Sincliar home		13405 Wright Avenue		Pioneer , setting of home
Britton Home		6720 Peach Orchard Road		Artesian well supplies gardens
J.R. Cambell home	Don Cameron	13810 Highway 97	1907	Unique architecture, Reeve, early home
Diacite Columns	District of Summerland	Western slope of Giants Head Mountain		Formed from resurgent volcanic dome
Jack Logie Cabin	Creekside Cottages	15216 Lakeshore Drive	1920	Site of meetings, art centre
Prof. Broad		9106 Jones Flat	1910	University of Calgary, lost 3 sons in WW1
Coulter-White Home		5503 White Avenue	1915	Pastor, active citizen, setting of home, site of Tulip shows
Rippin Barn		14901 Dale Meadows Road	1912	Unique stone foundation, setting of barn
Featherstonhaugh home		10617 Rutherford Avenue	1904	Pre-fab, one of first homes in Summerland

Heritage Lost

1. Lord Shaughnessy home: founder of Summerland May 7 1994
2. MacDonald School demolished to make room for Track and Field Facility
3. CPR Wharf
4. Morton Hall known as "House on the Hill" part of the original Okanagan College
5. Judge Kelley's Home on Rosedale significantly altered
6. Methodist Church Manse, exterior architecture destroyed
7. Darke House: pioneer, Darke Lake, Darke Lake Provincial Park, Darke Creek

Annual Recognized Heritage Buildings

Year Designated		Year Constructed
1987	St. Stephen's Anglican Church (The Stone Church)	1909
1988	A. Biagioni Home (Stonehouse)	1916-1921
1989	R.H. Agur Home (Balcomo Lodge)	1906
1990	William Ritchie Home	1910
1991	Spencer Sisters' Home	1909
1992	A.H. Steven Home	1910
1993	Major E.E. Hutton Home (Bredon Hill)	1909
1994	Barclay Ranch House	1887
1995	Landry Log Cabin	1890
1996	Bank of Montreal	1917
1997	Superintendent's Residence	1923
1998	Lakeside Church	1909
1999	R.B. Angus Orchard Home	1904
2000	Methodist Church Manse	1907
2001	Colonel R. Cartwright Home	1907
2002	Hogg Store	1909
2003	Harvey Home	1907
2004	Balcomo Post Office	1907
2005	Arthur Day Barn	1889
2006	Darke Home	1903
2007	McAlpine Home	1909
2008	Bowering Home	1912
2009	Logie's Log Cabin	1920
2010	Bank Manager's Home (Faircrest)	1910
2011	George Ryga Centre	1930
2012	Sir Edward Clouston home	1910
2013	Issac Blair home	1910
2014	"Ted" Atkinson home	1930

HERITAGE SITES INVENTORY

Summerland has two heritage sites that require protection. Priest Camp Historic Park is a 50 acre park on the shores of Garnett Lake. First indentified on maps in 1846, it is the first non-native settlement in the Okanagan Valley and the first non-fortified settlement in British Columbia.

The second heritage site the Okanagan Fur Brigade Linear Park. This park was created for Summerland's Centennial in 2006. It is a 4.1 km linear park which extends from Priest Camp to the northern boundary

of Summerland. It then extends an additional 0.9 km into the Central Okanagan Regional District as leased land. This trail has been estimated to be 6,000 years old, 1500 years older than the Egyptian pyramids !

Annual Recognized Heritage Sites (with signage)

Priest Camp
 Millionaires Row
 Granite City Waggon Trail
 Barclay Ranch House
 Aeneas Creek
 Okanagan College
 LowerTown
 Centennial Trail
 Brigade Trail / Cariboo Trail (Municipal Linear Park)
 George Ryga Centre
 Flume Line on Morrow Avenue
 Peach Orchard Cemetery

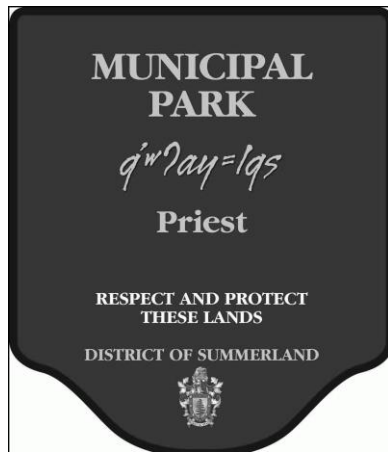

Priest Camp Historic Park
 Established in February
 Summerland's
 1998. Settlement created
 in 1845



Okanagan Fur Brigade Trail Linear Park
 One of two parks created for

Centennial in 2006

SUMMERLAND HERITAGE TREE INVENTORY

<u>TREE</u>	<u>LOCATION</u>	<u>DATE</u>	<u>HISTORY</u>
Oak	Anglican Church	1953	planted by Mrs Harrison
Beech & Blue Spruce	Ferlins, Peach Orchard Road	1920	C.A. Walters

Twin Oaks	Martens, Fosbery Rd	1916	Walter Wright
Birches	PARC	1920	Nat May
Leaning pines	Stan Ochman Giants Head Rd.		
Maple & Acacia	Marg McAfee		Alex Stevens
Tulip tree	Edith Verity, Nixon Rd	1912	Edith Verity
Birches	Memorial Park	1948	Memorial Parks Committee DOS
Dawn Redwood	Wharton Street	1953	
Ten Firs	John Beaven Switchback Rd.		C.A. Walters
2 Ponderosa	Peach Orchard campground	prior 1900	Barclay Peach Orchard George Barclay
Maples*	Barclay Ranch House Victoria Road	1891	
Maples	Davis Weins Mountain Road	1930	Len Mountford
Rain-Golden	Dr. David McIntosh Nixon Road	1961	
Elm	Allan Lewis Happy Valley Rd	1924	Herbert Lewis
Maples	Doells Washington Ave.	1911	Will Ritchie
Chestnuts	Randy Beggs Peach Orchard Rd	1920	Mrs. Hookham
Blue Spruce	Ken Steuart Quinpool Road		
Cedars	Kiwanis Village Quinpool Road	1919	Tom Washington
Maples	Bruce Blagborne		Bert Harvey
Birches	Ted Atkinson Hillborn Ave.	1924	Ted Atkinson
Apple	PARC	1860	Father

* removed Nov 2012

****NEW LOST HERITAGE****

7. Gartrell Barn
8. Featherstonhaugh home
9. Tree in front of the Barclay Ranch house dated 1897 or earlier

Suggestions

1. Ken Hogg house
2. Gutormusson house
3. Ralph White house